

Please read and save these instructions. Read through this owner's manual carefully before using product. Protect yourself and others by observing all safety information, warnings, and cautions. Failure to comply with instructions could result in personal injury and/or damage to product or property. Please retain instructions for future reference.



PPS-I PERSONAL POWER SOURCE WITH SMART JUMP CABLES

FOR CUSTOMER SERVICE

Technical Question?

CALL 1-866-458-2472

customerservice@oem-tools.com

UNPACKING

After unpacking unit, inspect carefully for any damage that may have occurred during transit. Check for loose, missing, or damaged parts. If any damage is observed, a shipping damage claim must be filed with carrier. Do not use the OEMTOOLS Personal Power Source if broken, bent, cracked or damaged parts (including labels) are noted. Any Personal Power Source that appears damaged in any way, operates abnormally or is missing parts should be removed from service immediately. If you suspect that the Personal Power Source was subjected to shock load (a load that was dropped suddenly, unexpectedly, etc.) immediately discontinue use until it has been checked by a factory authorized service center.



⚠ WARNING

The following safety information is provided as guidelines to help you operate your Personal Power Source under the safest possible conditions. Any tool or piece of equipment can be potentially dangerous to use when safety or safe handling instructions are not known or not followed. The following safety instructions are to provide the user with the information necessary for safe use and operation. Please read and retain these instructions for the continued safe use of your service system. Failure to follow instructions listed below may result in serious injury. In addition, make certain that anyone that uses the equipment understands and follows these safety instructions as well.

WARNING: Pursuant to California Proposition 65, this product contains chemicals known to the state of California to cause cancer and birth defects or other reproductive harm. Wash hands after handling.

Explanation of Safety Signal Words

⚠ WARNING : Indicates a potentially hazardous situation which, if not avoided, could result in death or serious injury.

⚠ CAUTION : Indicates a potentially hazardous situation which, if not avoided, may result in minor or moderate injury.

CAUTION : Used without the safety alert symbol indicates a potentially hazardous situation which, if not avoided, may result in property damage.

Notes : Provide clarity and helpful information.



PPS-I PERSONAL POWER SOURCE WITH SMART JUMP CABLES

Thank you very much for choosing an OEMTOOLS Product!

For future reference, please complete the owner's record below:

Model: _____ **Purchase Date:** _____

Save the receipt, warranty and these instructions. It is important that you read the entire manual to become familiar with this product before you begin using it. This machine is designed for certain applications only. OEMTOOLS cannot be responsible for issues arising from modification. We strongly recommend this machine is not modified and/or used for any application other than that for which it was designed. If you have any questions relative to a particular application, DO NOT use the machine until you have first contacted OEMTOOLS to determine if it can or should be performed on the product.

For technical questions please call 1-866-458-2472.



IMPORTANT INSTRUCTIONS AND SAFETY RULES

1. Know your tool. Read this manual carefully. Learn the tool's applications and limitations, as well as, potential hazards specific to it.
 2. Keep work area clean and well lit. Cluttered or dark work areas invite accidents.
 3. Keep children away. All children should be kept away from the work area. Never let a child handle a tool without strict adult supervision.
 4. Do not operate this tool if under the influence of alcohol or drugs. Read warning labels on prescriptions to determine if your judgment or reflexes are impaired while taking drugs. If there is any doubt, do not attempt to operate.
 5. Use safety equipment. Eye protection should be worn at all times when operating this tool. Use ANSI approved safety glasses. Everyday eyeglasses are NOT safety glasses. Dust mask, non-skid safety shoes, hard hat or hearing protection should be used in appropriate conditions.
 6. Wear proper apparel. Loose clothing, gloves, neckties, rings, bracelets or other jewelry may present a potential hazard when operating this tool. Keep all apparel clear of the tool.
 7. Don't overreach. Keep proper footing and balance at all times when operating this tool.
 8. Check for damage. Check your tool regularly. If part of the tool is damaged it should be carefully inspected to make sure that it can perform its intended function correctly. If in doubt, the part should be repaired. Refer all servicing to a qualified technician. Consult your dealer for advice.
 9. Keep away from flammables. Do not attempt to operate this tool near flammable materials or combustibles. Failure to comply may cause serious injury or death.
 10. Store idle tools out of the reach of children and untrained persons. Tools may be dangerous in the hands of untrained users.
- Maintain tools with care.
 - Keep tools dry and clean.
 - Do not use a damaged tool. Tag damaged tools "Do not use" until repaired.
 - If damaged, have the tool serviced before using. Many accidents are caused by poorly maintained tools.
 - Use only accessories that are recommended by the manufacturer for your model. Accessories that may be suitable for one tool may become hazardous when used on another tool.
 - Tool service must be performed only by qualified repair personnel. Service or maintenance performed by unqualified personnel could result in a risk of injury.
 - When servicing a tool, use only identical replacement parts. Use of unauthorized parts or failure to follow maintenance instructions may create a risk of injury.
 - Maintain a safe working environment. Keep the work area well lit. Make sure there is adequate surrounding workspace. Keep the work area free of obstructions, grease, oil, trash, and other debris. Do not use this product in a damp or wet location.
 - Maintain labels and nameplates on this product. These carry important information. If unreadable or missing, contact OEMTOOLS for a replacement.
 - Before use, read and understand all warnings, safety precautions, and instructions as outlined in the vehicle manufacturer's service manual. It is beyond the scope of this manual to properly describe the correct procedure and test data for each vehicle.
 - Always perform vehicle service in a properly ventilated area. Never run an engine without proper ventilation for its exhaust. Stop work and take



PPS-I PERSONAL POWER SOURCE WITH SMART JUMP CABLES

necessary steps to improve ventilation in the work area if you develop momentary eye, nose, or throat irritation as this indicates inadequate ventilation.

- Engine parts that are in motion and unexpected movement of a vehicle can injure or kill. When working near moving engine parts, wear snug fit clothing and keep hands and fingers away from moving parts. Keep hoses and tools clear of moving parts. Always stay clear of moving engine parts. Hoses and tools can be thrown through the air if not kept clear of moving engine parts. The unexpected movement of a vehicle can injure or kill. When working on vehicles always set the parking brake or block the wheels.
- Avoid accidental fire and/or explosion. Do not smoke near engine fuel and battery components.
- We believe the information contained herein to be reliable. However, general technical information is given by us without charge and the user shall employ such information at his own discretion and risk. We assume no responsibility for results or damages incurred from the use of such information in whole or in part. Always refer to specific instructions and technical information supplied by manufacturer of vehicle or any other item you intend to connect the OEMTOOLS Personal Power Source to.
- The manufacturer declines any and all responsibility for damage to vehicles or components if said damage is the result of unskillful handling by the operator or of failure to observe the basic safety rules set forth in the instruction manual.

WARNING

Read Rules for Safe Operation and Instructions Carefully

PERSONAL PRECAUTIONS AND SAFETY

- Working in vicinity of a lead-acid battery is dangerous. Batteries generate explosive gases during normal battery operation. For this reason, it is of utmost importance that each time before using your Personal Power Source, you read this manual and follow the instructions exactly.

WARNING: Wear complete eye protection and clothing protection, when working with lead-acid batteries.

1. Use only attachments recommended or sold by manufacturer. Use of non-recommended attachments may result in fire, electric shock, or injury.

2. Do not disassemble Personal Power Source. Take it to a qualified professional when service or repair is required. Incorrect reassembly may result in electric shock or fire.
3. To reduce risk of electric shock, unplug charger from outlet before attempting any maintenance or cleaning.
4. Make sure someone is within range of your voice or close enough to come to your aid when you work with or near a lead-acid battery.
5. Have plenty of fresh water and soap nearby for use if battery acid contacts skin, clothing, or eyes. If battery acid contacts skin or clothing, wash immediately with soap and water.
6. Avoid touching your eyes while working with a battery. Acid particles (corrosion) may get into your eyes! If acid enters your eye, immediately flood eye with running cold water for at least 10 minutes. Get medical attention immediately.
7. Remove all personal metal items such as rings, bracelets, necklaces, and watches when working with a lead-acid battery. A lead-acid battery can produce a short-circuit current high enough to weld a ring (or the like) to metal, causing a severe burn.
8. Take care not to drop a metal tool or other metal onto the battery. Metal may cause sparking or short circuit the battery or another electrical devise. Sparking may cause an explosion.
9. **NEVER smoke or allow a spark or flame in the vicinity of the battery or engine.** Batteries generate explosive gases!

GENERAL BATTERY SAFETY

- To reduce the risk of battery explosion, follow these instructions and those published by the battery manufacturer and the manufacturer of any equipment you intend to use in the vicinity of a battery. Review cautionary markings on these products and on the engine.
- When connecting to a battery in the vehicle, take care to determine which post is grounded. To reduce risk of a spark near battery, follow these steps when battery is installed in vehicle.

WARNING: A spark near a battery may cause battery explosion.

WARNING: Risk of electric shock or fire.

1. Stay clear of fan blades, belts, pulleys and other parts that can cause injury.



PPS-I PERSONAL POWER SOURCE WITH SMART JUMP CABLES

2. Check polarity of battery posts. Battery case will be marked by each post: POSITIVE (POS, P, +) and NEGATIVE (NEG, N, -). NOTE: The positive battery post usually has a larger diameter than the negative post.
3. Determine which post of battery is ground (connected) to chassis.

NOTE: The negative post is normally grounded.

IMPORTANT SAFETY INSTRUCTIONS

The warnings, precautions, and instructions discussed in this manual cannot cover all possible conditions and situations that may occur. The operator must understand that common sense and caution are factors which cannot be built into this product, but must be supplied by the operator.

DISPOSAL

At the end of the useful life of the OEMTOOLS Personal Power Source, dispose of the components according to all state, federal, and local regulations.

PURPOSE

The OEMTOOLS PPS-I Personal Power Source with Smart Jump Cables is a power source that is pocket sized but powerful enough to start a car, light duty truck, motorcycles, boat or ATV many times and can also charge cell phones, tablets and cameras.

PRODUCT SPECIFICATIONS

Size	5.2" x 3.0" x 1.0"
Weight	11 Oz
Battery Capacity	29.6 Watt
Output	5V=2A; 12V Jump Start
Input	14V=1A
Full Charging Time	3 Hours
Starting Current	200A
Peak Current	400A
Operating Temperature	-5°F ~ 140°F

⚠ WARNING

1. Always make sure the blue plug of the jumper cable is fully engaged in the jump start socket before jump starting the vehicle. This can limit the available power and may cause damage or melting of the blue plug.
2. Always make sure jumper clamps are well connected, check if the vehicle's battery connections are rusted or dirty and if necessary, clean before jumping start the vehicle.
3. DO NOT attempt to jump start more than 3 times. Otherwise, it can damage the OEMTOOLS Personal Power Source. If your vehicle will not start, check for other problems.
4. DO NOT connect the two clamps. Otherwise, it may be dangerous!
5. DO NOT disassemble the OEMTOOLS Personal Power Source. Otherwise, it may be dangerous!
6. DO NOT put fingers or hands into any of the unit's outlets.
7. DO NOT expose the unit to rain or snow.
8. Never place the unit directly above battery being jumped.
9. DO NOT use the unit to jump start a vehicle while charging the internal battery.
10. DO NOT permit the internal battery of the unit to freeze. Never charge a frozen battery.
11. Consider having someone nearby to come to your aid when you work near a lead-acid battery.

❗ Always take care when using this power source

⚠ This power source is not intended for use by young or infirm persons without supervision

⚠ Do not use as a toy

⚠ Do not allow the power source to become wet. Do not immerse power source in water

⚠ Do not operate the power source in explosive atmospheres, such as in the presence of flammable liquids, gases or dust

⚠ Do not expose the power source to heat. Do not store in locations where the temperature may exceed 70°C

❗ Charge only at ambient temperatures between -5°F ~ 140°F. Charge only using the charger provided with the power source

❗ At the end of their useful life, discard the power source with due care for our environment



PPS-I PERSONAL POWER SOURCE WITH SMART JUMP CABLES

- Charge only using the charger provided with the OEMTOOLS Personal Power Source
- Under extreme conditions, battery leakage may occur. Carefully wipe the liquid off using a cloth and avoid skin contact when you notice liquid on the batteries. In case of skin or eye contact, rinse immediately with clean water and seek medical attention.

- Do not attempt to jump start Diesel Engines

A. PRODUCT LAYOUT :

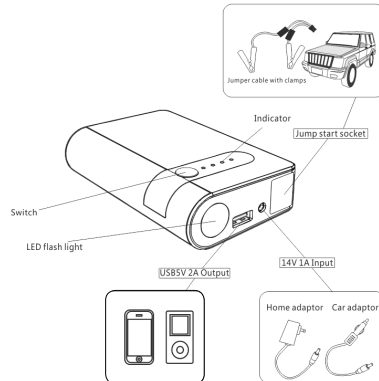

INDICATOR

Press the switch to check the charge level of the OEMTOOLS Personal Power Source

The indicator lights will flash one by one during charging.

Different number of solid indicators show charge level of the OEMTOOLS Personal Power Source. All indicators light up when the charging is paused or completed.

Indicator	Storage Level
1 Flashing	0%
1 Solid	25%
2 Solid	50%
3 Solid	75%
4 Solid	100%

BATTERY CHARGING INSTRUCTIONS

IMPORTANT! CHARGE IMMEDIATELY AFTER PURCHASE, AFTER EACH USE AND EVERY 3-6 MONTHS, TO KEEP THE INTERNAL BATTERY FULLY CHARGED AND PROLONG BATTERY LIFE.

The OEMTOOLS Personal Power Source Charging Instructions:

1. Plug the home adaptor into the universal socket.
2. Connect 12V 1A input port of the OEMTOOLS Personal Power Source to the other end of home adaptor

OR

3. Plug the car adaptor into the socket of cigarette lighter.

4. Connect 14V 1A input port of the OEMTOOLS Portable Power Source to the other end of car adaptor.

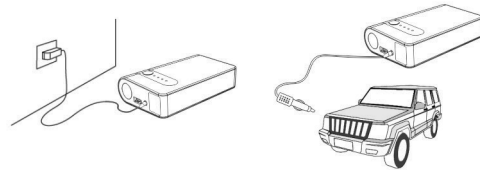

SMART JUMP CABLES START 12V GASOLINE VEHICLE INSTRUCTIONS:

PREPARATION INSTRUCTIONS

1. Clean the battery terminals before using the jump starter. During cleaning, keep airborne corrosion from coming into contact with your eyes, nose and mouth. Use baking soda and water to neutralize the battery acid and help eliminate airborne corrosion. Do not touch your eyes, nose or mouth.
2. Determine the voltage of the battery by referring to the vehicle owner's manual and make sure that the output voltage of the jump starter is correct.
3. Make sure that the unit's cable clamps make tight connections.
4. Position the DC cables to reduce the risk of damage by the hood, door and moving or hot engine parts. **NOTE:** If it is necessary to close the hood during the jump starting process, ensure that the hood does not touch the metal part of the battery clips or cut the insulation of the cables.

OPERATION INSTRUCTIONS

1. Plug the jumper cable into the jump starter's input socket. Make sure the indicator of the cable controller is off.
2. Connect the Red Clamp to the (+) battery terminal and the Black Clamp to the negative (-) battery terminal.
3. Observe the indicator light of the cable controller.

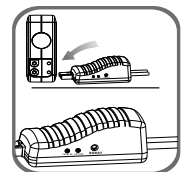

3A. GREEN Light on: Crank the engine. If the engine does not start within 5-8 seconds, stop cranking and wait at least 1 minute before attempting to start the vehicle again.

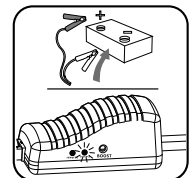



PPS-I PERSONAL POWER SOURCE WITH SMART JUMP CABLES

3B. RED Light on with Audio Alarm:

You have connected the clamps backwards. Check the connection and reverse the connections. The Audio Alarm will stop after correct connection made.

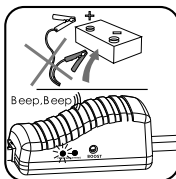

3C. GREEN Light blinking: Battery voltage of vehicle is too low.

Press the "BOOST" button on black control box. Once GREEN indicator is on, crank the engine within 30 seconds.

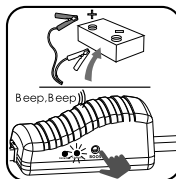

3D. No Light is on, No Audio Alarm: Dead battery or no battery. Make sure the connection is correct, and then press the "BOOST" button. Once the GREEN indicator is on, crank the engine within 30 seconds.

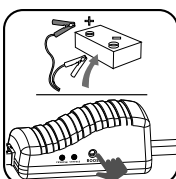

- Start the vehicle.
- Remove the jumper cable from the jump starter within 39 seconds after the engine has started.
- Remove jumper cable from the car battery.

CHARGING CELL PHONE OR TABLET INSTRUCTION:

- Plug the pigtail cable B into the USB 5V 2A output port.

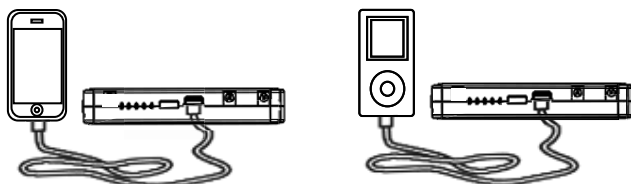

- Select appropriate connector and connect it to your mobile phones or tablet.
- Press the switch button to charge.

FOR POWER SUPPLY TO 12V VEHICLE ACCESSORIES OR 12V ELECTRONICS

- Plug the optional pigtail cable to 12V 10A output port.
- Connect the optional pigtail cable and 12V vehicle accessories or 12V electronics.
- Press the switch button to power supply.

LED FLASH LIGHT

Press the switch 3 seconds to start the LED flash light. Lightly press again to change light modes.

There are 3 light modes to flashlight: Standard, Strobe and SOS.

Figure	Description	Quantity
A	Personal Power Source Battery Unit	1
B	5V-2A USB Port with Pigtail Adapters	1
C	Wall Charger	1
D	Auto Charger	1
E	Smart Jumper Cables	1
F	Durable Storage Case (Not Shown)	1

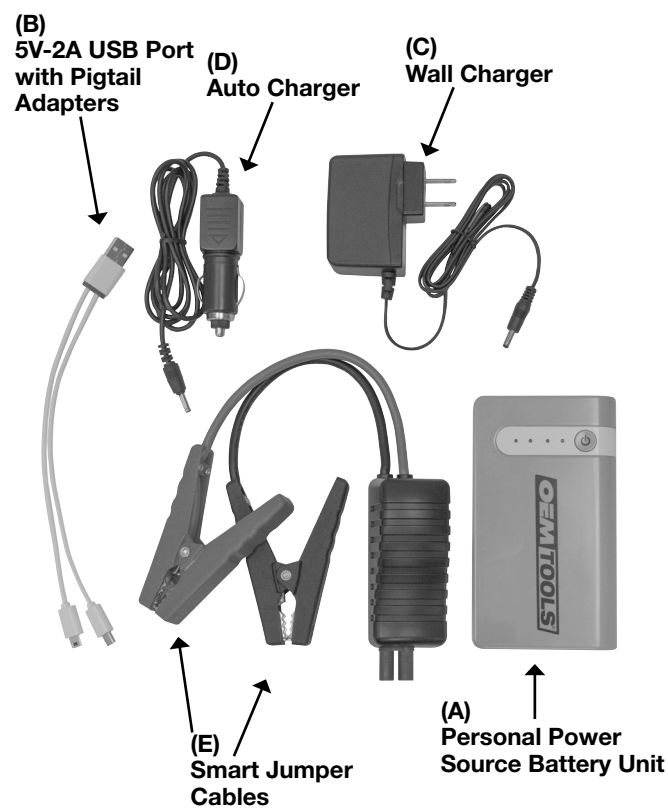



PPS-I PERSONAL POWER SOURCE WITH SMART JUMP CABLES

MAINTENANCE

Very little maintenance is required for the OEMTOOLS Portable Power Source. Follow common sense in wiping the charger clean and store in a clean, dry area.

1. After use, wipe all battery corrosion and other dirt or oil from clip, cord, and the OEMTOOLS Portable Power Source case. Use a dry cloth.
2. Coil charger cords to prevent damage.
3. Replace any cracked or frayed cords.
4. Store the OEMTOOLS Personal Power Source in a clean, dry area.

FREQUENTLY ASKED QUESTIONS

- A. How do I turn off the Power Source?
The Power Source will power off automatically when no load or when charging is complete.
- B. How many times can this Power Source charge my mobile phone?
A minimum of 4 times for most mobile phones, depending on brand.
- C. How long will it take to charge my mobile phone?
Approximately 1 hour, depending on type of mobile phone.
- D. When fully charged, how many times can this power source start my car?
Approximately 10 times; if fully charged.
- E. How long will the power source keep its battery charge?
Battery will retain its charge for approximately 6-12 months depending on conditions. We recommend recharging the power source every 3 months, so it's fully charged in an emergency.

TROUBLE SHOOTING:

Finding	Cause	Remedies
The OEMTOOLS Portable Power Source is still not fully charged while it's 5 indicator lights are solid.	Charger may auto stop at 60% if battery is very low to prevent damage.	Unplug the adaptor and plug it in again.
No response when pressing the switch button.	Low voltage protection of the OEMTOOLS Portable Power Source.	Plug the adaptor into the 12V 1A input to recharge.

TOXIC AND HARMFUL SUBSTANCES:

Composition and amount of toxic and harmful substances in the Multi-Use Personal Power Source with Jumper Cables					
Pb	Hg	Cd	Cr(VI)	PBB	PBDE
0	0	0	0	0	0
0: Indicate all homogeneous materials' hazardous substances content are below the MCV limit specified in the Standard 2002/95/EC(RoHs).					



PPS-I PERSONAL POWER SOURCE WITH SMART JUMP CABLES

OEMTOOLS™ 90 DAYS LIMITED WARRANTY

From 90 days from the original purchase of this product, OEMTOOLS will warranty this item. If you find any defect in material or workmanship, through normal usage, return it to the place of purchase or to OEMTOOLS for repair or replacement at our discretion. In order to obtain this service send your tool and proof of purchase, transportation pre-paid, to OEMTOOLS Q.A. Dept., 3580 E. Raines Road #3, Memphis, TN 38118. We will not be responsible for lost or damaged goods during transportation, please insure your package. If our inspection verifies the defect, we will either repair or replace the product at our election, or we may elect to refund the purchase price if we cannot readily and quickly provide you with a replacement. We will return repaired products at our expense, but if we determine there is no defect, or that the defect resulted from causes not within the scope of our warranty, then you must bear the cost of returning the product.

OEMTOOLS does not provide warranty for products labeled other than OEM or OEMTOOLS. OEMTOOLS will not provide any warranty for products subjected to abnormal use. Abnormal use includes, but is not limited to, abuse, accident, alteration, neglect, and unauthorized or unreasonable use or repairs. This warranty does not cover bits, blades, files, batteries, or calibration. We recommend that you maintain your tools and sharpen or replace blades, bits, files, and batteries as necessary. OEMTOOLS reserves the right to make any changes in construction or design at any time without any obligation in incorporating such changes to tools or equipment previously sold.

OEMTOOLS makes every effort to assure that its products meet high quality and durability standards, and warrants to the original purchaser that this product is free from defects in materials and workmanship for the period of 90 days from the date of purchase. This warranty does not apply to damage due directly or indirectly to misuse, abuse, negligence or accidents, repairs or alterations outside our facilities, criminal activity, improper installation, normal wear and tear or to lack of maintenance.

We shall in no event be liable for death, injuries to persons or property, or for incidental, contingent, special or consequential damages arising from the use of our product. Some states do not allow the exclusion or limitation of incidental or consequential damages, so the above limitation of exclusion may not apply to you. THIS WARRANTY IS EXPRESSLY IN LIEU OF ALL OTHER WARRANTIES, EXPRESS OR IMPLIED, INCLUDING THE WARRANTIES OF MERCHANTABILITY AND FITNESS. This warranty gives you specific legal rights, and you may also have other rights, which vary from state to state.



CONTACT US

3580 E. Raines Road, Suite 3, Memphis, TN 38118

Tel: 1-866-458-2472

www.customerservice@oem-tools.com