

Please read and save these instructions. Read through this owner's manual carefully before using product. Protect yourself and others by observing all safety information, warnings, and cautions. Failure to comply with instructions could result in personal injury and/or damage to product or property. Please retain instructions for future reference.



SMART JUMP CABLES

(USE WITH MOST PERSONAL POWER SOURCES
WITH JUMP STARTS)

FOR CUSTOMER SERVICE

Technical Question?

CALL 1-866-458-2472

customerservice@oem-tools.com

UNPACKING

After unpacking unit, inspect carefully for any damage that may have occurred during transit. Check for loose, missing, or damaged parts. If any damage is observed, a shipping damage claim must be filed with carrier.

Do not use the OEMTOOLS Smart Jump Cables if broken, bent, cracked or damaged parts (including labels) are noted. Any Smart Jump Cables that appears damaged in any way, operates abnormally or is missing parts should be removed from service immediately. If you suspect that the Smart Jump Cables was subjected to shock load (a load that was dropped suddenly, unexpectedly, etc.) immediately discontinue use until it has been checked by a factory authorized service center.



⚠ WARNING

The following safety information is provided as a guideline to help you operate your Smart Jump Cables under the safest possible conditions. Any tool or piece of equipment can be potentially dangerous to use when safety or safe handling instructions are not known or not followed. The following safety instructions are to provide the user with the information necessary for safe use and operation. Please read and retain these instructions for the continued safe use of your service system. Failure to follow instructions listed below may result in serious injury. In addition, make certain that anyone that uses the equipment understands and follows these safety instructions as well.

Explanation of Safety Signal Words

⚠ WARNING : Indicates a potentially hazardous situation which, if not avoided, could result in death or serious injury.

⚠ CAUTION : Indicates a potentially hazardous situation which, if not avoided, may result in minor or moderate injury.

CAUTION : Used without the safety alert symbol indicates a potentially hazardous situation which, if not avoided, may result in property damage.

Notes : Provide clarity and helpful information.

⚠ WARNING Pursuant to California Proposition 65, this product contains chemicals known to the state of California to cause cancer and birth defects or other reproductive harm. Wash hands after handling.



SMART JUMP CABLES

Thank you very much for choosing an OEMTOOLS Product!

For future reference, please complete the owner's record below:

Model: _____ **Purchase Date:** _____

Save the receipt, warranty and these instructions. It is important that you read the entire manual to become familiar with this product before you begin using it. This machine is designed for certain applications only. OEMTOOLS cannot be responsible for issues arising from modification. We strongly recommend this machine is not modified and/or used for any application other than that for which it was designed. If you have any questions relative to a particular application, DO NOT use the machine until you have first contacted OEMTOOLS to determine if it can or should be performed on the product.

For technical questions please call 1-866-458-2472.



IMPORTANT INSTRUCTIONS AND SAFETY RULES

1. Know your tool. Read this manual carefully. Learn the tool's applications and limitations, as well as, potential hazards specific to it.
 2. Keep work area clean and well lit. Cluttered or dark work areas invite accidents.
 3. Keep children away. All children should be kept away from the work area. Never let a child handle a tool without strict adult supervision.
 4. Do not operate this tool if under the influence of alcohol or drugs. Read warning labels on prescriptions to determine if your judgment or reflexes are impaired while taking drugs. If there is any doubt, do not attempt to operate.
 5. Use safety equipment. Eye protection should be worn at all times when operating this tool. Use ANSI approved safety glasses. Everyday eyeglasses are NOT safety glasses. Dust mask, non-skid safety shoes, hard hat or hearing protection should be used in appropriate conditions.
 6. Wear proper apparel. Loose clothing, gloves, neckties, rings, bracelets or other jewelry may present a potential hazard when operating this tool. Keep all apparel clear of the tool.
 7. Don't overreach. Keep proper footing and balance at all times when operating this tool.
 8. Check for damage. Check your tool regularly. If part of the tool is damaged it should be carefully inspected to make sure that it can perform its intended function correctly. If in doubt, the part should be repaired. Refer all servicing to a qualified technician. Consult your dealer for advice.
 9. Keep away from flammables. Do not attempt to operate this tool near flammable materials or combustibles. Failure to comply may cause serious injury or death.
 10. Store idle tools out of the reach of children and untrained persons. Tools may be dangerous in the hands of untrained users.
- Maintain tools with care.
 - Keep tools dry and clean.
 - Do not use a damaged tool. Tag damaged tools "Do not use" until repaired.
 - Use only accessories that are recommended by the manufacturer for your model. Accessories that may be suitable for one tool may become hazardous when used on another tool.
 - Tool service must be performed only by qualified repair personnel. Service or maintenance performed by unqualified personnel could result in a risk of injury.
 - When servicing a tool, use only identical replacement parts. Use of unauthorized parts or failure to follow maintenance instructions may create a risk of injury.
 - Maintain a safe working environment. Keep the work area well lit. Make sure there is adequate surrounding workspace. Keep the work area free of obstructions, grease, oil, trash, and other debris. Do not use this product in a damp or wet location.
 - Maintain labels and nameplates on this product. These carry important information. If unreadable or missing, contact OEMTOOLS for a replacement.
 - Before use, read and understand all warnings, safety precautions, and instructions as outlined in the vehicle manufacturer's service manual. It is beyond the scope of this manual to properly describe the correct procedure and test data for each vehicle.
 - Always perform vehicle service in a properly ventilated area. Never run an engine without proper ventilation for its exhaust. Stop work and take necessary steps to improve ventilation in the work area if you develop momentary eye, nose, or throat irritation as this indicates inadequate ventilation.



SMART JUMP CABLES

WARNING

- Engine parts that are in motion and unexpected movement of a vehicle can injure or kill. When working near moving engine parts, wear snug fit clothing and keep hands and fingers away from moving parts. Keep hoses and tools clear of moving parts. Always stay clear of moving engine parts. Hoses and tools can be thrown through the air if not kept clear of moving engine parts. The unexpected movement of a vehicle can injure or kill. When working on vehicles always set the parking brake or block the wheels.
- Avoid accidental fire and/or explosion. Do not smoke near engine fuel and battery components.

Note: The manufacturer declines any and all responsibility for damage to vehicles or components if said damage is the result of unskillful handling by the operator or of failure to observe the basic safety rules set forth in the instruction manual.

WARNING

Read Rules for Safe Operation and Instructions Carefully.

PERSONAL PRECAUTIONS AND SAFETY

- Working in vicinity of a lead-acid battery is dangerous. Batteries generate explosive gases during normal battery operation. For this reason, it is of utmost importance that each time before using your Smart Jump Cables, you read this manual and follow the instructions exactly.

WARNING

Wear complete eye protection and clothing protection, when working with lead-acid batteries.

1. Use only attachments recommended or sold by manufacturer. Use of non-recommended attachments may result in fire, electric shock or injury.
2. Do not disassemble the Smart Jump Cables. Take it to a qualified professional when service or repair is required. Incorrect reassembly may result in electric shock or fire.
3. Make sure someone is within range of your voice or close enough to come to your aid when you work with or near a lead-acid battery.
4. Have plenty of fresh water and soap nearby for use if battery acid contacts skin, clothing or eyes.

If battery acid contacts skin or clothing, wash immediately with soap and water.

5. Avoid touching your eyes while working with a battery. Acid particles (corrosion) may get into your eyes! If acid enters your eye, immediately flood eye with running cold water for at least 10 minutes. Get medical attention immediately.
6. Remove all personal metal items such as rings, bracelets, necklaces, and watches when working with a lead-acid battery. A lead-acid battery can produce a short-circuit current high enough to weld a ring (or the like) to metal, causing a severe burn.
7. Take care not to drop a metal tool or other metal onto the battery. Metal may cause sparking or short circuit the battery or another electrical device. Sparking may cause an explosion.
8. **NEVER smoke or allow a spark or flame in the vicinity of the battery or engine.** Batteries generate explosive gases!

GENERAL BATTERY SAFETY

- To reduce the risk of battery explosion, follow these instructions and those published by the battery manufacturer and the manufacturer of any equipment you intend to use in the vicinity of a battery. Review cautionary markings on these products and on the engine.
- When connecting to a battery in the vehicle, take care to determine which post is grounded. To reduce risk of a spark near battery, follow these steps when battery is installed in vehicle.

WARNING: A spark near a battery may cause battery explosion.

WARNING: Risk of electric shock or fire.

1. Stay clear of fan blades, belts, pulleys and other parts that can cause injury.
2. Check polarity of battery posts. Battery case will be marked by each post: POSITIVE (POS, P, +) and NEGATIVE (NEG, N, -). NOTE: The positive battery post usually has a larger diameter than the negative post.
3. Determine which post of battery is ground (connected) to chassis.

NOTE: The negative post is normally grounded.



SMART JUMP CABLES

IMPORTANT SAFETY INSTRUCTIONS

The warnings, precautions, and instructions discussed in this manual cannot cover all possible conditions and situations that may occur. The operator must understand that common sense and caution are factors which cannot be built into this product, but must be supplied by the operator.

DISPOSAL

At the end of the useful life of the OEMTOOLS Personal Power Source, dispose of the components according to all state, federal, and local regulations.

PURPOSE

The Smart Jump Cables are intelligent cables that verify proper connection, making jump starting safe and easy.

PRODUCT SPECIFICATIONS

Size	14" x 1.5" x 1.5"
Weight	0.5 Lbs.
Power Source	80000 MaH
Operating Temperature	-5°F ~ 140°F

GENERAL SAFETY

1. Always make sure the blue plug of the jumper cable is fully engaged in the jump start socket before jump starting the vehicle. This can limit the available power and may cause damage or melting of the blue plug.
2. Always make sure jumper clamps are well connected, check if the vehicle's battery connections are rusted or dirty and if necessary, clean before jumping start the vehicle.
3. DO NOT attempt to jump start more than 3 times. Otherwise, it can damage the OEMTOOLS Personal Power Source. If your vehicle will not start, check for other problems.
4. DO NOT connect the two clamps. Otherwise, it may be dangerous!
5. DO NOT disassemble the OEMTOOLS Personal Power Source. Otherwise, it may be dangerous!
6. DO NOT put fingers or hands into any of the unit's outlets.
7. DO NOT expose the unit to rain or snow.
8. Never place the unit directly above battery being jumped.
9. DO NOT use the unit to jump start a vehicle while charging the internal battery.
10. DO NOT permit the internal battery of the unit to freeze. Never charge a frozen battery.
11. Consider having someone nearby to come to your aid when you work near a lead-acid battery.
12. This power source is not intended for use by young or infirm persons without supervision.
13. DO NOT use as a toy.
14. DO NOT allow the power source to become wet.
15. DO NOT immerse power source in water.
16. DO NOT operate the power source in explosive atmospheres, such as in the presence of flammable liquids, gases or dust.
17. DO NOT expose the power source to heat. Do not store in locations where the temperature may exceed 70°C.
18. Charge only at ambient temperatures between -5°F ~ 140°F. Charge only using the charger provided with the power source.
19. At the end of their useful life, discard the power source with due care for our environment. Charge only using the charger provided with the OEMTOOLS Personal Power Source.
20. Under extreme conditions, battery leakage may occur. Carefully wipe the liquid off using a cloth and avoid skin contact when you notice liquid on the batteries. In case of skin or eye contact, rinse immediately with clean water and seek medical attention.
21. DO NOT attempt to jump start Diesel Engines.
22. Never leave the jumper cables connected to the Personal Power Source when storing.



SMART JUMP CABLES

SMART JUMP CABLES START 12V GASOLINE VEHICLE INSTRUCTIONS:

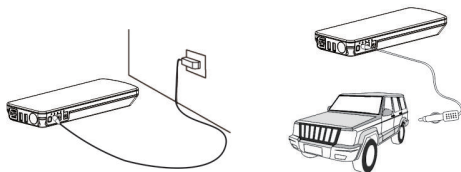

PREPARATION INSTRUCTIONS

1. Clean the battery terminals before using the jump starter. During cleaning, keep airborne corrosion from coming into contact with your eyes, nose and mouth. Use baking soda and water to neutralize the battery acid and help eliminate airborne corrosion. Do not touch your eyes, nose or mouth.
2. Determine the voltage of the battery by referring to the vehicle owner's manual and make sure that the output voltage of the jump starter is correct.
3. Make sure that the unit's cable clamps make tight connections.
4. Position the DC cables to reduce the risk of damage by the hood, door and moving or hot engine parts. **NOTE:** If it is necessary to close the hood during the jump starting process, ensure that the hood does not touch the metal part of the battery clips or cut the insulation of the cables.

OPERATION INSTRUCTIONS

1. Plug the jumper cable into the jump starter's input socket. Make sure the indicator of the cable controller is off.
2. Connect the Red Clamp to the (+) battery terminal and the Black Clamp to the negative (-) battery terminal.
3. Observe the indicator light of the cable controller.

3A. GREEN Light on: Crank the engine. If the engine does not start within 5-8 seconds, stop cranking and wait at least 1 minute before attempting to start the vehicle again.

3A.

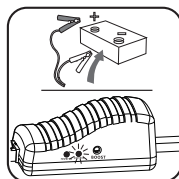

3B. RED Light on with Audio Alarm: You have connected the clamps backwards. Check the connection and reverse the connections. The Audio Alarm will stop after correct connection made.

3B.

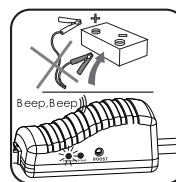

3C. GREEN Light blinking: Battery voltage of vehicle is too low. Press the "BOOST" button on The Smart Module. Once GREEN indicator is on, crank the engine within 30 seconds.

3C.

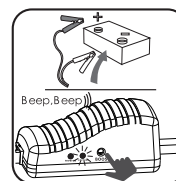

3D. No Light is on, No Audio Alarm: Dead battery or no battery. Make sure the connection is correct, and then press the "BOOST" button. Once the GREEN indicator is on, crank the engine within 30 seconds.

3D.

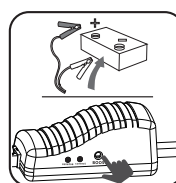

4. Start the vehicle.
5. Remove the jumper cable from the jump starter within 39 seconds after the engine has started.
6. Remove jumper cable from the car battery.

MAINTENANCE

Very little maintenance is required for the OEMTOOLS Smart Jump Cables. Follow common sense in wiping the charger clean and store in a clean, dry area.

1. After use, wipe all battery corrosion and other dirt or oil from clip, cord, and the OEMTOOLS Portable Power Source case. Use a dry cloth.
2. Coil charger cords to prevent damage.
3. Replace any cracked or frayed cords.
4. Store the OEMTOOLS Personal Power Source in a clean, dry area.

TOXIC AND HARMFUL SUBSTANCES:

Composition and amount of toxic and harmful substances in the Multi-Use Personal Power Source with Jumper Cables.					
Pb	Hg	Cd	Cr(VI)	PBB	PBDE
0	0	0	0	0	0
0: Indicate all homogeneous materials' hazardous substances content are below the MCV limit specified in the Standard 2002/95/EC(RoHS).					



SMART JUMP CABLES

Figure	Description	Quantity
A	Red Clamp (+)	1
B	Black Clamp (-)	1
C	Leads	2
D	The Smart Module	1
E	Plug	1
F	Boost Button (Not Shown)	1

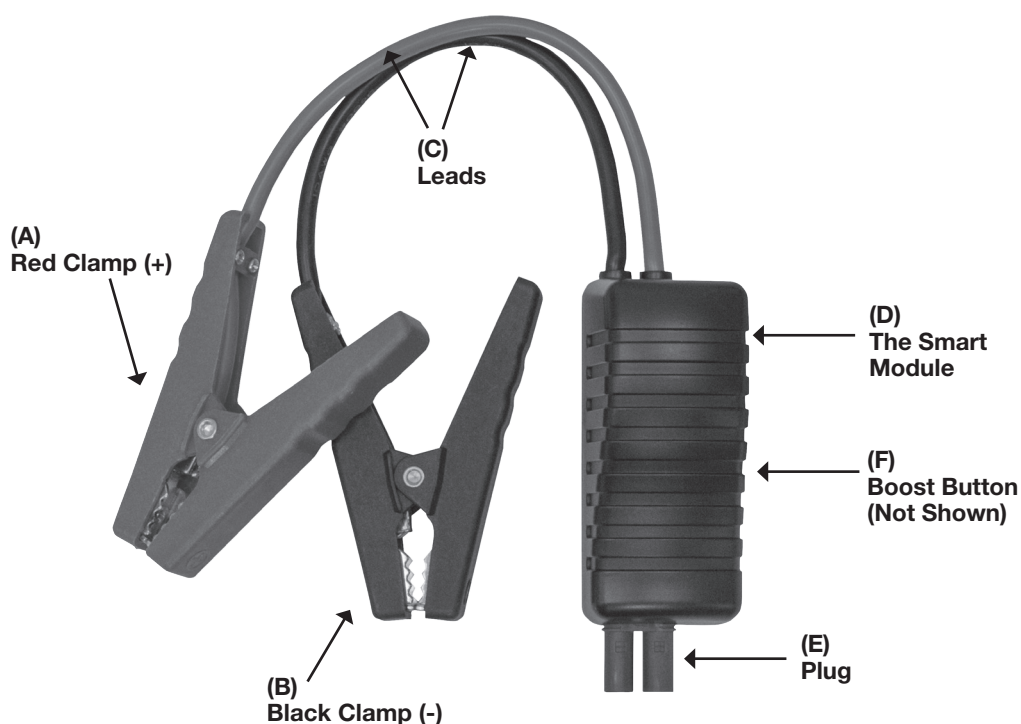

Applied Standard : GB/T 18287-2000

CONTACT US

3580 E. Raines Road, Suite 3, Memphis, TN 38118
 Tel: 1-866-458-2472
www.oem-tools.com