

Please read and save these instructions. Read through this owner's manual carefully before using product. Protect yourself and others by observing all safety information, warnings, and cautions. Failure to comply with instructions could result in personal injury and/or damage to product or property. Please retain instructions for future reference.



4800W 240V SHOP HEATER

FOR CUSTOMER SERVICE

Technical Question?

CALL 1-866-458-2472
customerservice@oem-tools.com

UNPACKING

After unpacking the unit, inspect carefully for any damage that may have occurred during transit. Check for loose, missing, or damaged parts. If any damage is observed, a shipping damage claim must be filed with the carrier. DO NOT use the OEMTOOLS™ 4800W 240V Shop Heater if broken, bent, cracked, or damaged parts (including labels) are noted. Any Heater that appears damaged in any way, operates abnormally or is missing parts should be removed from service immediately. If you suspect that the Heater was subjected to shock load (a load that was dropped suddenly, unexpectedly, etc.), immediately discontinue use until it has been checked by a factory authorized service center.



⚠ WARNING

The following safety information is provided as a guideline to help you operate your Shop Heater under the safest possible conditions. Any tool or piece of equipment can be potentially dangerous to use when safety or safe handling instructions are not known or not followed. The following safety instructions are to provide the user with the information necessary for safe use and operation. Please read and retain these instructions for the continued safe use of your tool. Failure to follow instructions listed below may result in serious injury. In addition, make sure that anyone who uses the equipment understands and follows these safety instructions as well.

Explanation of Safety Signal Words

⚠ WARNING: Indicates a potentially hazardous situation which, if not avoided, could result in death or serious injury.

⚠ CAUTION: Indicates a potentially hazardous situation which, if not avoided, may result in minor or moderate injury.

CAUTION: Used without the safety alert symbol indicates a potentially hazardous situation which, if not avoided, may result in property damage.

Thank you very much for choosing an OEMTOOLS™ Product!

For future reference, please register your new tool at www.oem-tools.com and complete the owner's record below:

Model: _____ **Purchase Date:** _____

Save the receipt, warranty and these instructions. It is important that you read the entire manual to become familiar with this product before you begin using it. This product is designed for certain applications only. OEMTOOLS™ cannot be responsible for issues arising from modification. We strongly recommend that this product is not modified and/or used for any application other than that for which it was designed. If you have any questions relative to a particular application, DO NOT use the product until you have first contacted customer service to determine if it can or should be performed on the product.



4800W 240V SHOP HEATER

! IMPORTANT INSTRUCTIONS AND SAFETY RULES

1. Know your product. Read this manual carefully. Learn the product's applications and limitations, as well as potential hazards specific to it.
2. Keep work area clean and well lit. Cluttered or dark work areas invite accidents.
3. Keep children away. All children should be kept away from the work area. Never let a child handle tools or equipment without strict adult supervision.
4. DO NOT operate this product if under the influence of alcohol or drugs. Read warning labels on prescriptions to determine if your judgment or reflexes are impaired while taking drugs. If there is any doubt, DO NOT attempt to operate.
5. Use safety equipment. Eye protection should be worn at all times when operating this tool. Use ANSI approved safety glasses. Everyday eyeglasses are NOT safety glasses. Dust mask, non-skid safety shoes, hard hat or hearing protection should be used in appropriate conditions.
6. Wear proper apparel. Loose clothing, gloves, neckties, rings, bracelets, or other jewelry may present a potential hazard when operating this product. Keep all apparel clear of the tool.
7. DO NOT overreach. Keep proper footing and balance at all times when operating this product.
8. Check for damage. Check your heater regularly. If part of the heater is damaged, it should be carefully inspected to make sure that it can perform its intended function correctly. If in doubt, the part should be repaired. Refer all servicing to a qualified technician. Consult your dealer for advice.
9. Keep away from flammables. DO NOT attempt to operate this product near flammable materials or combustibles. Failure to comply may cause serious injury or death.
10. Use only accessories that are recommended by the manufacturer for your model. Accessories that may be suitable for one product may become hazardous when used on another product.
11. Service must be performed only by qualified repair personnel. Service or maintenance performed by unqualified personnel could result in a risk of injury.
12. When servicing a product, use only identical replacement parts. Use of unauthorized parts or failure to follow maintenance instructions may create a risk of injury.
13. Maintain a safe working environment. Keep the work area well lit. Make sure there is adequate surrounding workspace. Keep the work area free of obstructions, grease, oil, trash, and other debris. DO NOT use this product in a damp or wet location.
14. Maintain labels and nameplates on this product. These carry important information. If unreadable or missing, contact OEMTOOLS™ for a replacement.
15. Avoid accidental fire and/or explosion. DO NOT smoke near engine fuel and battery components.
16. The warnings, precautions, and instructions discussed in this manual cannot cover all possible conditions and situations that may occur. The operator must understand that common sense and caution are factors which cannot be built into this product, but must be supplied by the operator.
17. We believe the information contained herein to be reliable. However, general technical information is given by us without charge and the user shall employ such information at their own discretion and risk. We assume no responsibility for results or damages incurred from the use of such information in whole or in part.
18. The manufacturer declines any and all responsibility for damage to property if said damage is the result of unskillful handling by the operator or of failure to observe the basic safety rules set forth in the instruction manual.
19. The procedures documented in this manual are to serve as guidelines for the use of this equipment.
20. The use of this equipment is simple and straightforward if you follow the instructions. When operating this equipment, use common sense, and only use this heater for its intended purpose.

PRODUCT DESCRIPTION

The OEMTOOLS™ 24824 4,800W 240V Shop Heater is a powerful yet compact heating solution for garages and workshops. It can be used as a portable heater with the convenient carry handle or mount it the wall or ceiling using the supplied bracket.

PRODUCT SPECIFICATIONS

Product Weight:	13 Lbs.
Dimensions:	10-3/4" (L) x 8-3/4" (W) x 12-1/2" (H) with carry handle installed
Input Voltage:	208-240V AC, 60Hz
Output Wattage:	3,600 - 4,800W
Amperage:	17 – 20A
BTU:	16,500

SPECIFIC SAFETY INSTRUCTIONS AND WARNINGS

⚠ WARNING: If the information in this manual is not followed exactly, a fire may result causing property damage, personal injury or loss of life. Please read and save these important safety instructions

⚠ WARNING: For your safety do not store or use gasoline or other flammable vapors or liquids in the vicinity of this or any other appliance

⚠ WARNING: When using electrical appliances, basic precautions should always be followed to reduce the risk of fire, electrical shock, and injury to persons, including the following:

1. This heater is hot when in use. To avoid burns, do not touch hot surfaces. If provided, use handles when moving this heater. Keep combustible materials at least 3 feet (0.9m) from the heater.



4800W 240V SHOP HEATER

2. Never leave heater unattended while in use. Keep children and pets away from heater while in use.
3. Always unplug heater when not in use.
4. DO NOT operate any heater with a damaged cord or plug or after the heater malfunctions, has been dropped or damaged in any manner.
5. Any repairs to this heater should be carried out by a qualified service person.
6. Under no circumstances should this heater be modified.
7. DO NOT use outdoors.
8. Use your heater only in dry environments. This heater is not intended for use in bathrooms, laundry areas and similar indoor locations. Never locate the heater where it may fall into water. DO NOT use near sinks, swimming pools or other damp areas such as flooded basements, garages, etc. or anywhere the heater could come in contact with water.
9. DO NOT run cord under carpeting. DO NOT cover cord with throw rugs, runners, or similar coverings. Arrange cord away from traffic area and where it will not be tripped over.
10. To disconnect heater, first turn controls to OFF, then remove plug from outlet. Always unplug the heater when not in use.
11. Connect to a properly grounded outlet only.
12. DO NOT insert or allow foreign objects to enter any ventilation or exhaust opening as this may cause an electrical shock, fire, or damage the heater.
13. To prevent a possible fire, do not block air intakes or exhaust in any manner. DO NOT use on soft surfaces where openings may become blocked.
14. This appliance may have internal arcing or sparks that could ignite flammable fumes. DO NOT use it in areas where gasoline, paint or flammable liquids are used or stored.
15. Use this heater only as described in this manual. Any other use not recommended by the manufacturer may cause fire, electric shock, or injury.
16. It is advised to avoid the use of an extension cord because the extension cord may overheat and cause a risk of fire.
17. This heater may include an audible or visual alarm to warn that parts of the heater are getting excessively hot. If the alert sounds or flashes, immediately turn the heater off and inspect for any objects on or adjacent to the heater that may cause high temperatures. DO NOT OPERATE THE HEATER WITH THE ALARM ACTIVATED.

CONTENTS

Heater Assembly, Mounting Bracket, Carry Handle and Wireless Remote

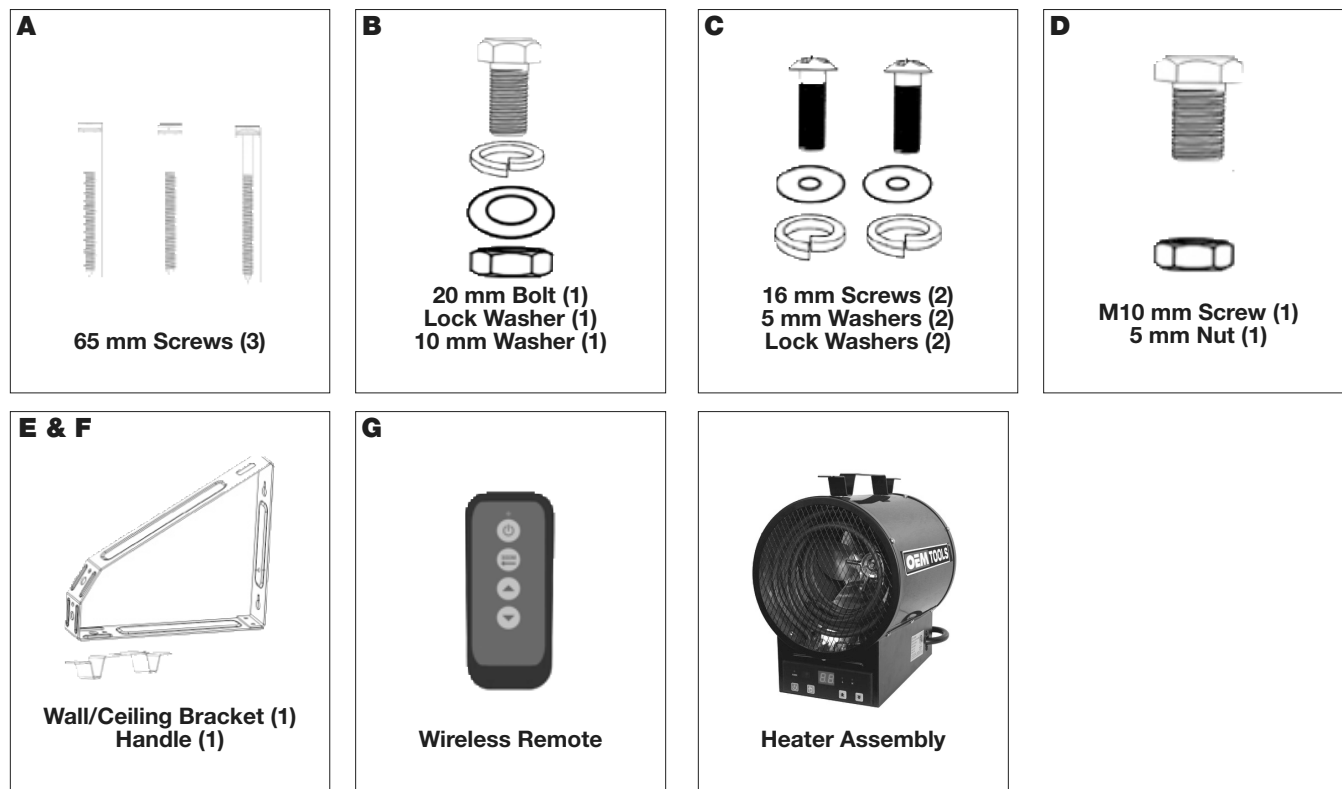



4800W 240V SHOP HEATER

ASSEMBLY FOR PORTABLE USE

1. Carefully remove all items from the packaging. Place onto a clean, protected surface capable of supporting the weight of the heater.
2. Attach the Carry Handle (F) using the (2) 16 mm screws (C), (2) 5 mm washers (C), and (2) lock washers (C).

⚠ WARNING

Minimum Clearance from Combustibles

3 ft. from Front

1 ft. from Top, Sides and Rear

WALL OR CEILING MOUNTING INSTRUCTIONS

Recommended Tools for Mounting

- Drill
- 4 mm or 5/32" Drill Bit
- Phillips Head Screwdriver
- Stud Finder
- Ratchet
- 17 mm socket and wrench

⚠ WARNING: Use appropriate fasteners. The screws provided are for installing in wood studs and joists only and not intended for metal joists.

1. Using a stud finder (not supplied), locate the wood stud in wall or joist in ceiling to mount heater.
2. Use holes in the Mounting Bracket (E) to mark 3 mounting hole locations for drilling.
3. Drill the 3 holes for 65 mm Mounting Screws (A).
4. Secure (2) 65 mm Mounting Screws (A) to wall or ceiling mounting location leaving 1/8" exposed. These screws must be securely mounted in a wood stud or joist.
5. Attach Mounting Bracket (E) to mounting location by inserting the two screws through the keyholes on the bracket and sliding into place.
6. Tighten the screws against the bracket to secure. Screw the third 65 mm Mounting Screw (A) into the mounting location through the hole in bracket.

ATTACHING HEATER TO MOUNTING BRACKET

7. Line up hole in Carry Handle (F) to one of the three Mounting Bracket (E) hole locations. (figures A, B, & C)
8. Attach Heater Assembly (H) to Mounting Bracket (E) with 20 mm Bolt, Nut, and both the flat and lock washer (B) using a 17 mm wrench and socket.

Figure A

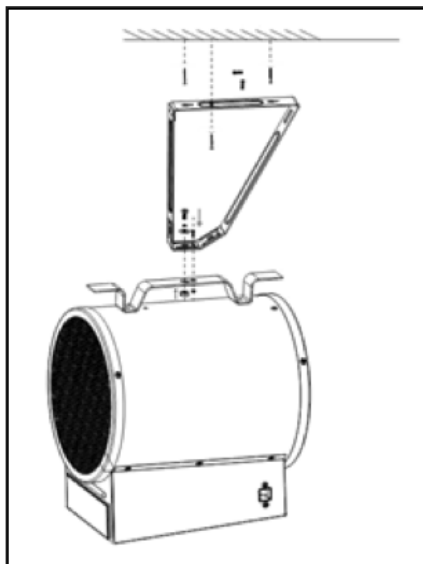

Wall Mount

Figure B

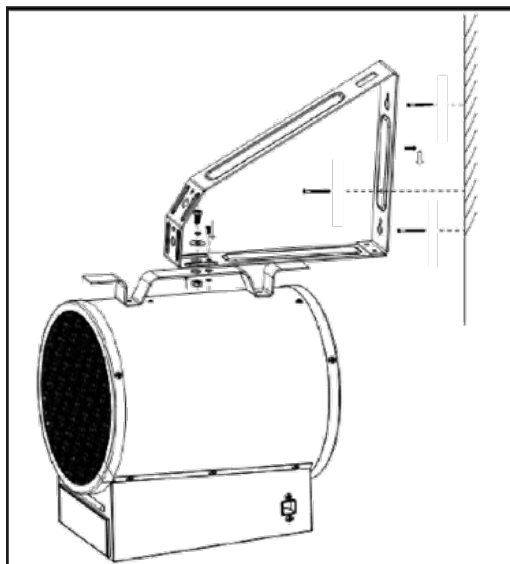

Ceiling Mount

Figure C

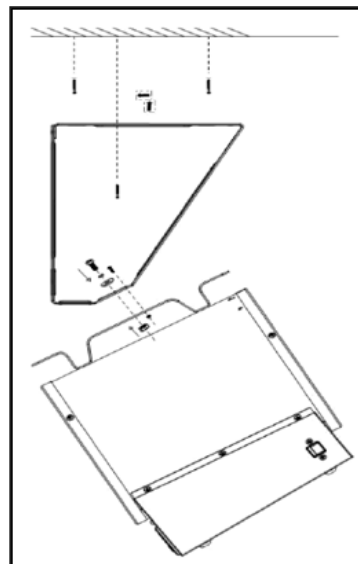

**Angled Ceiling
Mount**



4800W 240V SHOP HEATER

OPERATION

1. Connect the heater to the proper electrical outlet (see Grounding Instructions). Once plugged into the 30 Amp receptacle, the power indicator light will come on.
2. Push the power button, the display will flash and display the temperature. Note: if the room temperature is above the current thermostat setting on the unit, it will not heat.
3. Adjust the thermostat setting by pressing the green Mode Button twice and selecting the Up or Down Arrow Button to increase or decrease desired temperature.

USING TIMER FUNCTIONS

4. Press the green Mode Button on the control panel or remote three times. The digital display will change from displaying temperature to a time value.
5. Press the Up or Down Arrow Buttons on the control panel or remote for desired timer setting from 1-9 hour duration.



Grounding Instructions:

This heater is for use on 240 (208) volt circuits. The cord has a plug as shown below. No adapter is available for this blade configuration, and none should be used. The outlet type is a 240 (208) volt 30 Amp grounded outlet. When properly installed, it provides a ground connection through the cord to the heater to prevent the operator from electric shock.

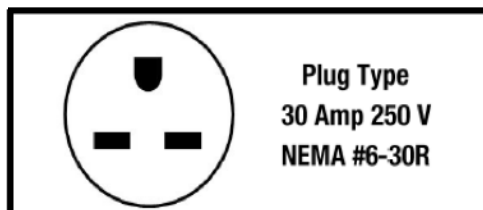

⚠ WARNING: Prior to operation, be sure that the electrical receptacle is of the configuration and capacity appropriate for the heater.

Note: When using the heater for the first time, you may notice a slight emission of smoke. This is normal and will stop after a short time. The heating element is made of steel and was coated with a layer of protective oil during production. Usage on outlets above 220 volts may cause a slight whistling sound due to the higher fan speed. This is normal and is not affecting the operation of the heater. This is not a defect.

⚠ WARNING: Electrical outlet wiring must comply with local building codes and other applicable regulations to reduce the risk of fire, electrical shock and injury.

⚠ WARNING: Do not use this appliance if any part of it has been underwater. Immediately call a qualified service technician to inspect the appliance and replace any part of the electrical system which has been under water.

AUTOMATIC OVERHEAT SAFETY CONTROL

This heater is equipped with an internal heat limiting thermostat and overheat protection circuit. When a potential overheat temperature is reached, the system will automatically shut the heater off.

IF SAFETY LIMIT LIGHT ILLUMINATES, an abnormal condition has turned off the heating elements.

TO RESET:

Wait 10 minutes to allow the heater to cool down; the heater will automatically reset once the heating element cools down.

MAINTENANCE

⚠ WARNING: Risk of electric shock - do not open - no serviceable parts inside

Any electrical repairs or rewiring of this unit should be carried out by a licensed electrician in accordance with national and local codes.

1. Before cleaning the heater, disconnect it from the power outlet and let it cool down.
2. Wipe off the heater assembly with a soft damp sponge and dry with a clean cloth. Be careful not to allow water into the unit.

DO NOT splash water onto the heater

DO NOT use a solvent to clean the heater

DO NOT open or attempt to clean inside of the heater

STORAGE

Allow heater to cool completely and store in a clean dry area.



4800W 240V SHOP HEATER

TROUBLESHOOTING

PROBLEM	CAUSE	SOLUTION
Heating element does not glow red	Stainless steel elements won't glow red to produce heat.	Heater is operating correctly
Do not feel heat or air flow	No power to heater	Check power connection to heater
	Desired room temperature reached	Thermostat will shut off heater once desired room temperature is reached
	Auto-Reset has tripped	Unplug heater, allow to cool down for 10 minutes, then restart
	Heater has fan only setting	Set to run on full power for heating.
Fan is running with no heat	Heater in cool down cycle	This is normal to disperse heat throughout the area. Turn thermostat up if additional heat is desired



This symbol designates that this tool is listed with U.S. requirements by ETL Testing Laboratories, Inc. Conforms to UL Std. 2021, CSA Std. C22.2 No.46.

**4800W 240V
SHOP HEATER****OEMTOOLS™ ONE YEAR WARRANTY**

If for up to one year from the date of purchase of this OEMTOOLS™ product you find any defect in material or workmanship, through normal usage, return it to the place of purchase, or to OEMTOOLS™ for repair or replacement at our discretion. In order to obtain this service, send the product and proof of purchase, transportation pre-paid, to OEMTOOLS™ Q.A. Dept, 3580 E. Raines Road #3, Memphis, TN 38118. We will not be responsible for lost or damaged goods during transportation; please insure your package. If our inspection verifies the defect, we will either repair or replace the product at our election, or we may elect to refund the purchase price if we cannot readily and quickly provide you with a replacement. We will return repaired products at our expense, but if we determine there is no defect, or that the defect resulted from causes not within the scope of our warranty, then you must bear the cost of returning the product.

OEMTOOLS™ does not provide warranty for products labeled other than OEM or OEMTOOLS™. OEMTOOLS™ will not provide any warranty for products subjected to abnormal use. Abnormal use includes, but is not limited to, abuse, accident, alteration, neglect, and unauthorized or unreasonable use or repairs. This warranty does not cover bits, blades, files, batteries, or calibration. We recommend that you maintain your tools and sharpen or replace blades, bits, files, and batteries as necessary. OEMTOOLS™ reserves the right to make any changes in construction or design at any time without any obligation in incorporating such changes to tools or equipment previously sold.

OEMTOOLS™ makes every effort to ensure that its products meet high quality and durability standards, and warrants to the original purchaser that this product is free from defects in materials and workmanship for the period of one year from the date of purchase. This warranty does not apply to damage due directly or indirectly to misuse, abuse, negligence or accidents, repairs or alterations outside our facilities, criminal activity, improper installation, normal wear and tear or to lack of maintenance.

We shall in no event be liable for death, injuries to persons or property, or for incidental, contingent, special or consequential damages arising from the use of our product. Some states do not allow the exclusion or limitation of incidental or consequential damages, so the above limitation of exclusion may not apply to you. THIS WARRANTY IS EXPRESSLY IN LIEU OF ALL OTHER WARRANTIES, EXPRESS OR IMPLIED, INCLUDING THE WARRANTIES OF MERCHANTABILITY AND FITNESS. This warranty gives you specific legal rights, and you may also have other rights, which vary from state to state.

CONTACT US

3580 E. Raines Road, Suite 3, Memphis, TN 38118
Tel: 1-866-458-2472
www.oem-tools.com

